

Gebrauchsanweisung | Instructions for use
Mode d'emploi | Modo de empleo
Modalità d'uso

Duplikat, Dubliform, Dubliplast®

Flüssigkonzentrat. Thermoreversibles Agar-Dubliefmaterial
Liquid concentrate. Thermoreversible duplicating gel
Gel de duplication en concentré liquide thermoréversible
Concentrado líquido. Gelatina duplicadora termoreversible
Concentrata liquida. Materiale da duplicazione a base di
agar termoreversibile

type 1, DIN EN ISO 14356



Sehr geehrte Kundin, sehr geehrter Kunde,

vielen Dank, dass Sie sich für ein Qualitätsprodukt aus dem Hause Dentaaurum entschieden haben.

Dear Customer

Thank you for having chosen a quality product from Dentaaurum.

Chère Cliente, cher Client,

Nous vous remercions d'avoir choisi un produit de la qualité Dentaaurum.

Estimadas/os clientes,

mucho le agradecemos que se haya decidido usted por un producto de calidad de la casa Dentaaurum.







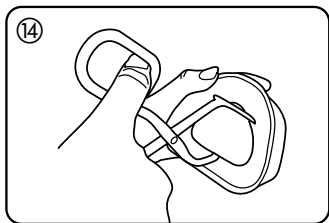
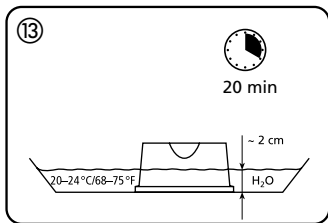
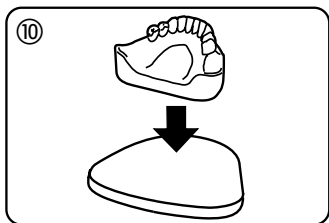
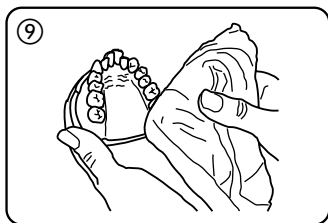
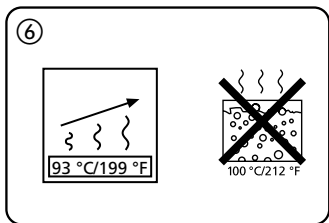
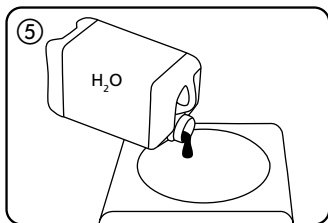
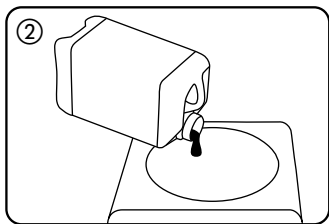
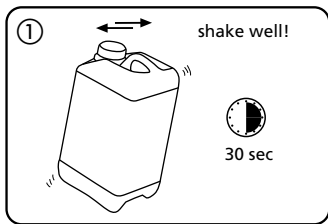

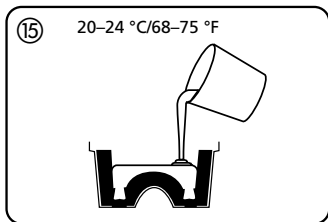
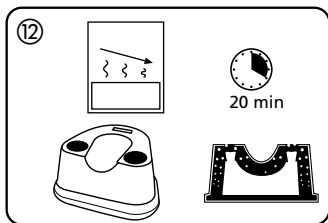
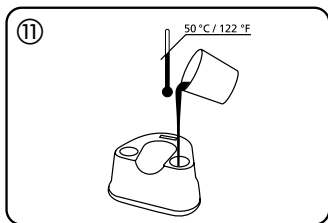
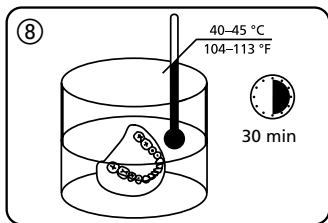
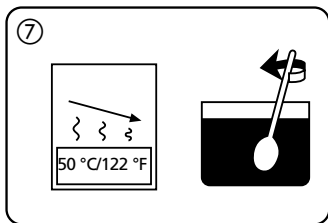
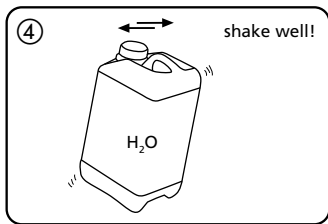
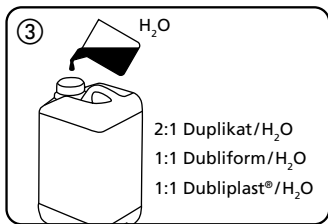
Egregio Cliente,

La ringraziamo per aver scelto un prodotto Dentaaurum.

Hotline +49 7231/803-410 · zahntechnik@dentaaurum.de · www.dentaaurum.com





	Duplikat concentrate	Dubliform concentrate	Dubliplast® concentrate
	•	•	•
	•	–	–
	•	•	•
	–	–	•
	•		•
	~20x	~15x	~15x
	108-605-00 3,0 l (3,7 kg)	108-550-00 2,5 l (2,9 kg)	165-550-00 2,5 l (2,7 kg)
	 5 l min. capacity		



Stand der Information
Date of information
Mise à jour
Fecha de la información
Data dell'informazione

2024-06

